



Densys PV5 GmbH

Saaläckerstraße 2

D-63801 Kleinostheim, Germany

Date: March 09, 2023

To whom it may concern:

We, Yingli Energy Development (Tianjin) Co., Ltd (hereinafter 'Yingli'), hereby declare that our "Limited Warranty for PV Modules" continues to be valid for modules of the type **YLxxxD-30b (1500V) 1/2** (YLM-L 120 CELL Half Cell) with dimension of 1684mm x 1002mm x 35mm and 1689mm x 996mm x 35mm and **YLxxxD-34d (1500V) 1/2** (YLM 120 CELL) with dimension of 1755mm x 1038mm x 35mm and **YLxxxD-37e (1500V)1/2** & **YLxxxDF54 e/2** with dimension of 1722 x 1134 x 30mm, regardless of the fact that the modules are mounted by **Densys PV5 GmbH**, or any customers **Densys PV5 GmbH** has sold these modules to, in deviation from the specification in our "Installation and User Manual" as described below and shown on the next page. This declaration is valid for solar PV projects located in **Europe and Switzerland** from the years 2020 and only under the conditions that:

For every module the **maximum downward load is less than 1520Pa and the maximum upward load is less than 1520Pa** and, no significant force is transferred to the modules due to distortion of any kind of the mounting structure or the roof. **Densys PV5 GmbH** or its customers are mounting these PV modules using clamping at 2 locations on each of the short sides or long sides of the module, one within the marked areas on the attachment (red arrows). For more details about the mounting method, please refer to the attachment.

This declaration does not grant any claims beyond the validity of the Yingli Solar "Limited Warranty for PV Modules". This declaration is valid from the years 2020. Renewal of this declaration in case of any change or upgrading of the module or Densys PV5 mounting approach will be reviewed and agreed by both parties.

Best Regards,

Murray Wang (王帅)

Tel.: +86 312 8632331

Mail: service@yingli.com

Accepted by Customer:

Name:

Signature/Date:



YLxxxD-30b (1500V) 1/2 Module dimension: 1684*1002mm or 1689*996mm

YLxxxD-34d (1500V) 1/2 Module dimension: 1755*1038*35mm

YLxxxD-37e (1500V) 1/2 & YLxxxDF54 e/2 Module dimension: 1722*1134*30mm

(xxx = Pmax)

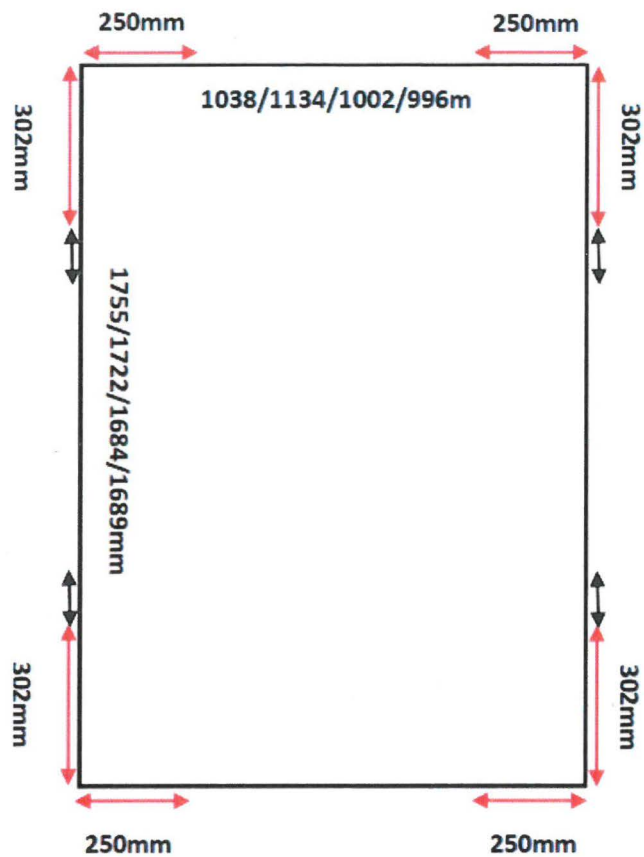

↔ Mounting Area corresponding to Yingli Installation and User Manual (100mm)

↔ Additional Mounting Area with lower Maximum downward and lower Maximum upward load

Imp (m.w)